



Irrigation Schedule:

PZ25- 1200001
11/05/2025



SYMBOL

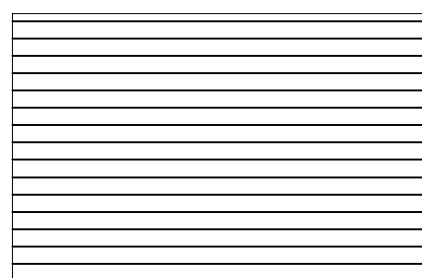

SYMBOL



MANUFACTURER/MODEL/DESCRIPTION

Hunter MP Strip PROS-06-PRS40-CV-F
Turf Rotator, 6" pop-up with factory installed check valve, floguard, pressure regulated to 40 psi, MP Rotator nozzle on PRS40 body. LST=Ivory left strip, SST=Brown side strip, RST=Copper right strip.

Hunter MP1000 PROS-06-PRS40-CV-F
Turf Rotator, 6" pop-up with check valve, floguard, pressure regulated to 40 psi, MP Rotator nozzle on PRS40 body. M=Maroon adj arc 90 to 210, L=Light Blue 210 to 270 arc, O=Olive 360 arc.

Hunter PROS-00-PCN 10
Flood Bubbler, on a PROS - 04.

MANUFACTURER/MODEL/DESCRIPTION

Hunter ICZ-101-25
Drip Control Zone Kit. 1" ICV Globe Valve with 1" HY100 filter system. Pressure Regulation: 25psi. Flow Range: 2 GPM to 20 GPM. 150 mesh stainless steel screen.

Pipe Transition Point in Drip Box

Area to Receive Dripline
Hunter HDL-06-18
On-Surface Pressure Compensating Landscape Dripline. 0.6 GPH emitters at 18" O.C. Dripline laterals spaced at 18" apart, with emitters offset for triangular pattern.

MANUFACTURER/MODEL/DESCRIPTION

Hunter PGV-100G-S
1" Plastic Electric Remote Control Valve, for Residential/Light Commercial Use. Slip x Slip. Globe Configuration, No Flow Control.

Gate Valve
Aqualine Gate Valve or approved equal

Febco 765 1"
Pressure Vacuum Breaker, brass with ball valve SOV. Install 12" (305MM) above highest downstream outlet and the highest point in the downstream piping.

Hunter PCC-600
Light Commercial & Residential Controller, 6-Station fixed controller, 120 VAC, Outdoor model

Hunter RAIN-CLIK
Rain Sensor, with conduit installation, mount as noted. Normally closed switch.

Irrigation Meter
1" Irrigation Meter

Irrigation Lateral Line: PVC Class 200

Irrigation Mainline: PVC Schedule 40

QTY

4

14

8

QTY

1

5

288.8 lf

QTY

2

1

1

1

1

1

790 lf

15 lf

Valve Callout

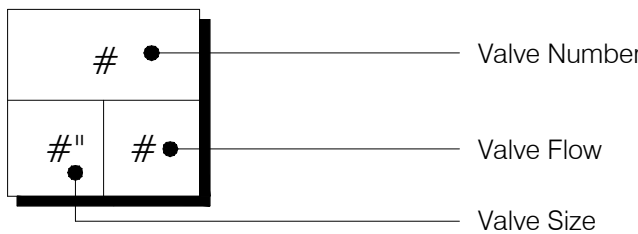

***Quantities to be field verified by contractor**
***All items listed may be substituted with LA/Owner approved equal**
***See sheet IR-02 for irrigation details & specifications**

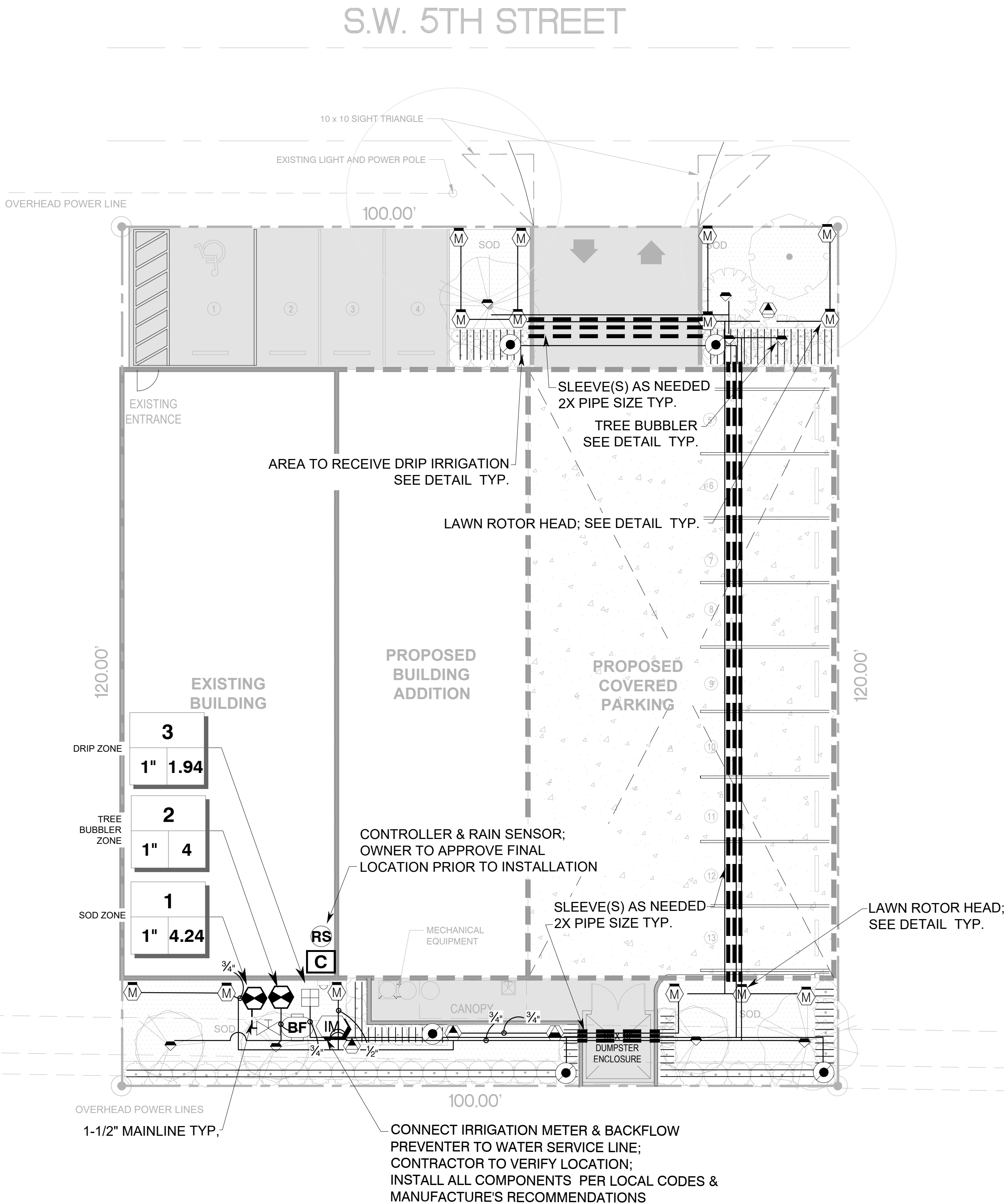

- The irrigation system shall be installed in accordance with requirements of the Building Code.
- The irrigation system rain-sensing cutoff device shall be located and installed so that building eaves, balconies, and similar overhangs do not interfere with effective operation of the device.
- The irrigation system shall be properly maintained in good working order and provide a minimum coverage of 100 percent with 50 percent overlap.
- Contractor to field locate mainline & laterals as needed to avoid conflicts with civil or landscape items.



PZ25-12000015

08/06/2025

Project Team

Landscape Architect:

LA LANDSCAPE
ARCHITECTURAL
SERVICES, LLC
Brandon White | Owner
772-834-1357 | brandon@las-fl.com
Paul Goulas | Owner
772-631-8400 | paul@las-fl.com
1708 SE Joy Haven Street
Port St. Lucie, FL 34983

Architect:

RAMOS ARCHITECTS & ASSOC.
780 Tamiami Canal Road
Miami, FL 33144
(305) 506-7388

Proposed Building Addition & Parking For:
50 S.W. 5th Street Pompano Beach, FL 33060
Irrigation Plan

Revisions

Date	Init.	Description
07.07.25	PG	Initial Submittal

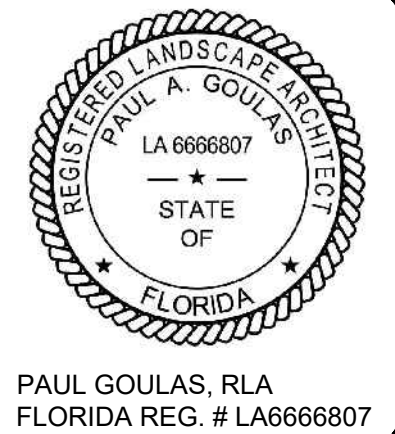

Drawn By: PG

Checked By: PG

Municipal Project:

Scale:

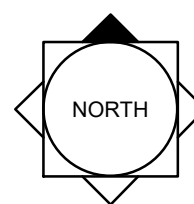

SCALE: 1" = 10'

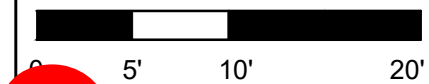

IR-01